



全能防水，快速安裝。
waterproof. Simple. Fast.



Feature

- Low cost & Durable.
- IP67.
- Small size.
- High brightness illuminated.
- PCB mounting and Panel snap-in.
- Multi-color LED available.

Application

Public building · Home Security · Business building · Industrial equipment...etc.

特色

低成本&耐用。

IP67防水防護等級。

帶燈高亮度。

PCB插件式&面板快速安裝

多種LED選擇

使用範圍

公共空間、居家、商用建築、機械設備

IP67

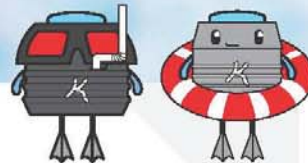



Waterproof Switches Series **SPK**

General Specifications

Current Rating	:50mA
Voltage Rating	:12VDC
Dielectric Withstanding Voltage	:250VAC for 1 minute
Contact Resistance	:100m Ohm Max.(initial)
Insulation Resistance	:100M Ohm Min.
Operating Force	:480gf±50gf
Total Travel	:0.3mm±0.1mm
Operating Life	:1,000,000 cycles Min.
Solder Specifications	:260 deg. for 3 seconds
Function	:Momentary(SPST)
Operating Temperature	:-10 deg.~+60 deg.

Materials

Cap	:Silicone
Base	:Polyamide (PA)
Switch Terminal	:Bronze with gold plating
Action Dome	:Phosphor bronze (PBS) with silver plating

▶ Circuit Diagram

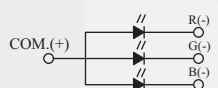
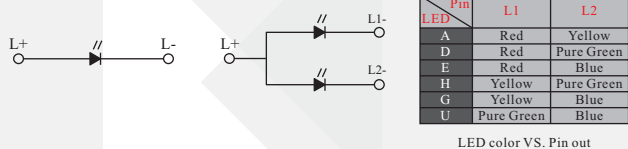
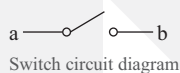

▶ SPKP PCB layout

Single color LED

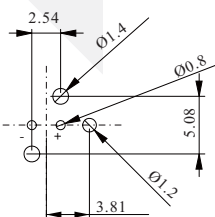

Dual Colors LED

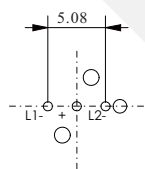

Full (RGB) Colors LED

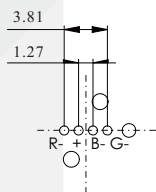

▶ Installation Notes

▶ SPKS

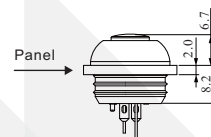
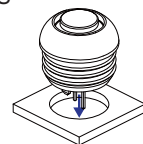

▶ SPKP

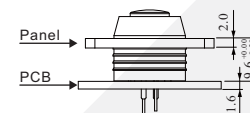
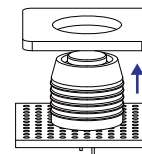

Panel cutting

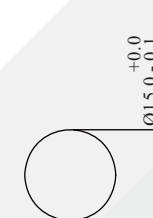

▶ SPKS Dimension

Single color LED

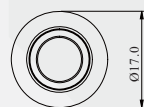

Dual Colors LED



Full (RGB) Colors LED

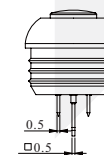
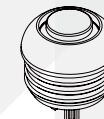
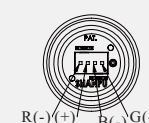
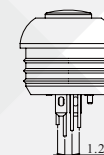
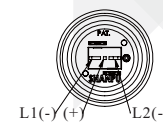
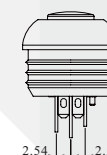
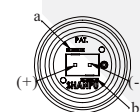
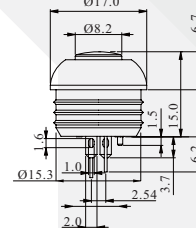



Waterproof Switches Series SPK

SPKP Dimension

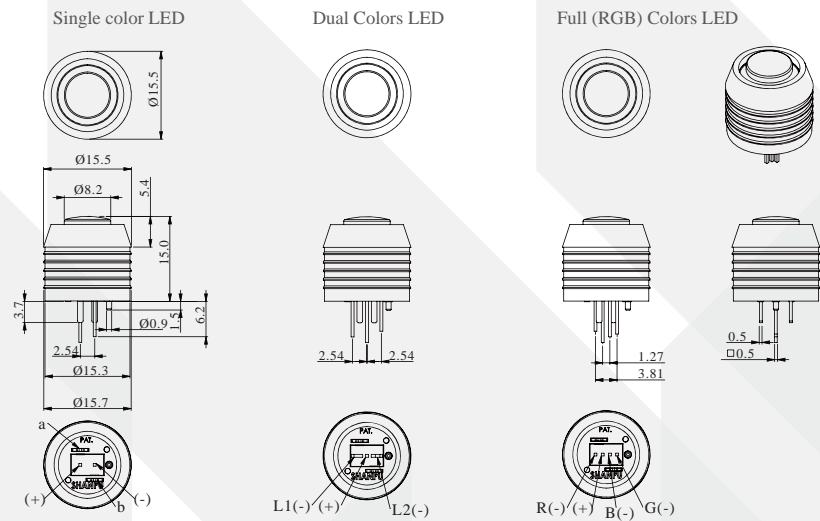

How to Order

